

RK Lite has reduced design time, improved product aesthetics by using SOLIDWORKS Premium 2018

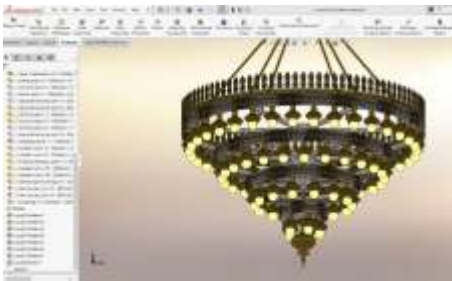
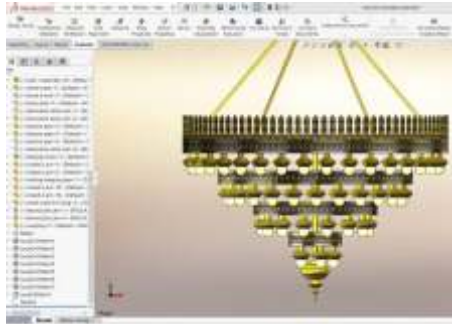

DECORATIVE LIGHTS

RK LITE GROUP

The R.K.Lite Group has its factory in Mumbai, India and was established way back in 1961. Within a very short span of time, the company emerged as one of the leading manufacturers of an extremely wide range of lighting fixtures that included chandeliers, table lamps, pedestal lamps, wall lamps, recessed lights and custom made fittings. In 1971, the company started exporting and since then it has grown multi folds.

Through stringent quality control and with the of an innovative Inhouse design team , these products became widely acclaimed for their unparalleled design aesthetics and their fail-safe durability. Today, these products have the pride of place at leading institutions and establishments all over Asia and the Middle East the Taj Group of Hotels, The Oberoi Group of Hotels, The Leela Kempinsky Group of Hotels, The Centaur Group of Hotels, Sheraton Hotels, and almost all the leading five-star hotels in India and several in Dubai, Sharjah and Russia to name a few.

“We are very satisfied with SOLIDWORKS software and technical Support by Addonix Technologies Pvt Ltd. It has proved beneficiary in accelerating our product development cycle, production and satisfying customer’s dynamic requirements. We would like to recommend SOLIDWORKS and Addonix Technologies to our friends in the industry”.

Mr. Sachin Kadam
Design Engineer



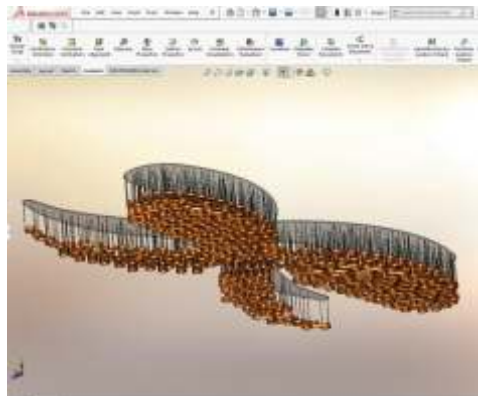
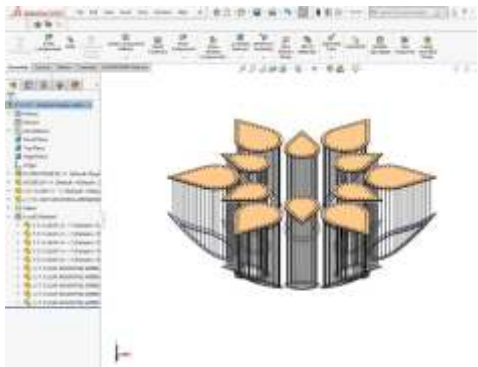
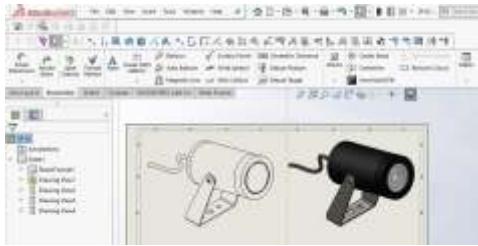

CHALLENGES

- Quick development of quality products & accelerating production
- Over designing of products
- Rationalise design time
- Design related communication with the client
- Better visualization of end product in the designing stage
- Design evaluation
- Reworking of parts in an assembly

SOLUTION

- Implemented SOLIDWORKS Premium software with the support of Addonix Technologies Pvt. Ltd. to develop new product concepts.

CUSTOMER BENEFITS...

- Faster product design - upto 70% faster on average allows you to beat your competition to market
- 3D modeling helps the designers and end users visualize space requirements, also improves drawing efficiency
- Automatic flattening of sheet metal parts (with bend allowance) and accuracy are very useful for our application
- Effective customer and interdepartmental communication with the help of renderings and animations
- Virtual prototypes reduce the need and cost of physical prototypes
- Data management proves a vital tool in organizing and managing your design data
- Automate your design process and increase speed and accuracy of output and response to customers
- Create effective marketing content

